

Straumann®  
Zygomatic Implant System  
Designed by experts with  
the patient in mind.







# Straumann® Zygomatic Implant System

## Designed by experts with the patient in mind.



At a glance



What's in it for you?



Clinical cases



Technical information



What customer say



Summary





# At a glance

The Straumann® Zygomatic Implant System provides an immediate, graftless, predictable fixed solution for edentulous patients and patients with terminal dentition.<sup>1,2,4</sup>

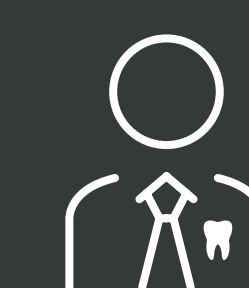



# What's in it for you?

From experts for experts

Immediate loading

Anatomically based designs

Straightforward prosthetics

Designed to adapt to patient's anatomy

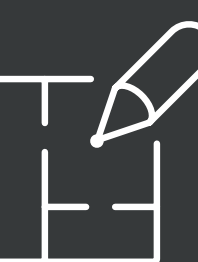





What's in it for you?

## From experts for experts

- Bringing experts together to provide a solution you can trust in.







What's in it for you?

## Immediate loading<sup>1,2,5</sup>

- Graftless solution that provides primary stability and allows immediate loading.

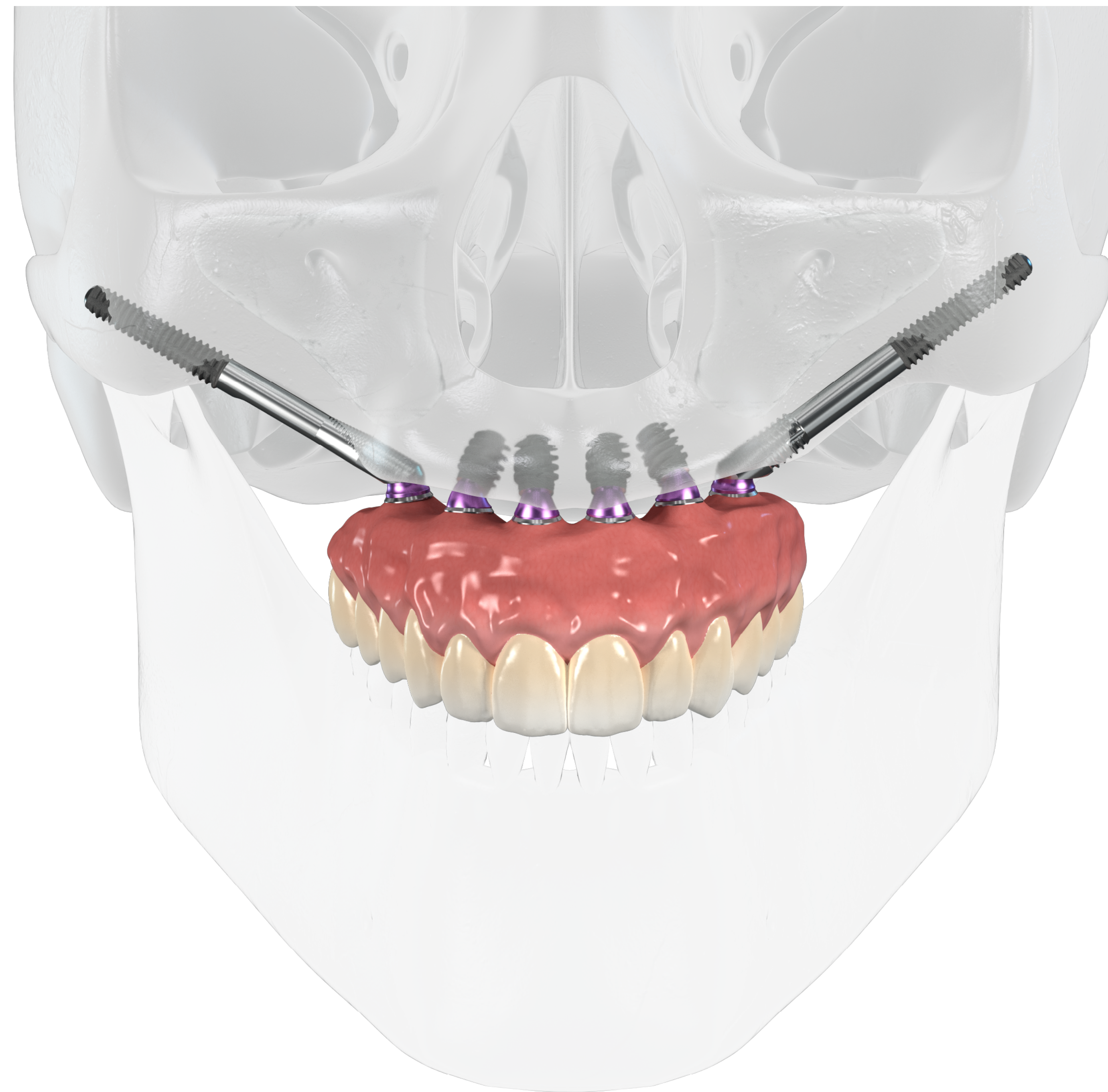

<sup>1</sup> Tuminelli FJ, Walter LR, Neugarten J, Bedrossian E. Immediate loading of zygomatic implants: A systematic review of implant survival, prosthesis survival and potential complications. Eur J Oral Implantol. 2017;10 Suppl 1:79-87. <sup>2</sup> Fatigue Testing Report – ZAGA Implant System. <sup>5</sup> Jung RE, Al-Nawas B, Araujo M, Avila-Ortiz G, Barter S, Brodala N, Chappuis V, Chen B, De Souza A, Almeida RF, Fickl S, Finelle G, Ganeles J, Gholami H, Hammerle C, Jensen S, Jokstad A, Katsuyama H, Kleinheinz J, Kunavisarut C, Mardas N, Monje A, Papaspyridakos P, Payer M, Schiegnitz E, Smeets R, Stefanini M, Ten Bruggenkate C, Vazouras K, Weber HP, Weingart D, Windisch P. Group 1 ITI Consensus Report: The influence of implant length and design and medications on clinical and patient-reported outcomes - Clin Oral Implants Res. 2018 Oct;29 Suppl 16:69-77.

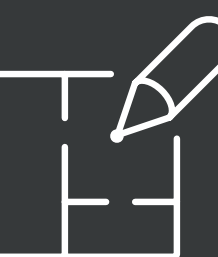





What's in it for you?

## Anatomically based designs

- Two designs with a unique combination of features to respect patients' anatomical structures.<sup>6</sup>

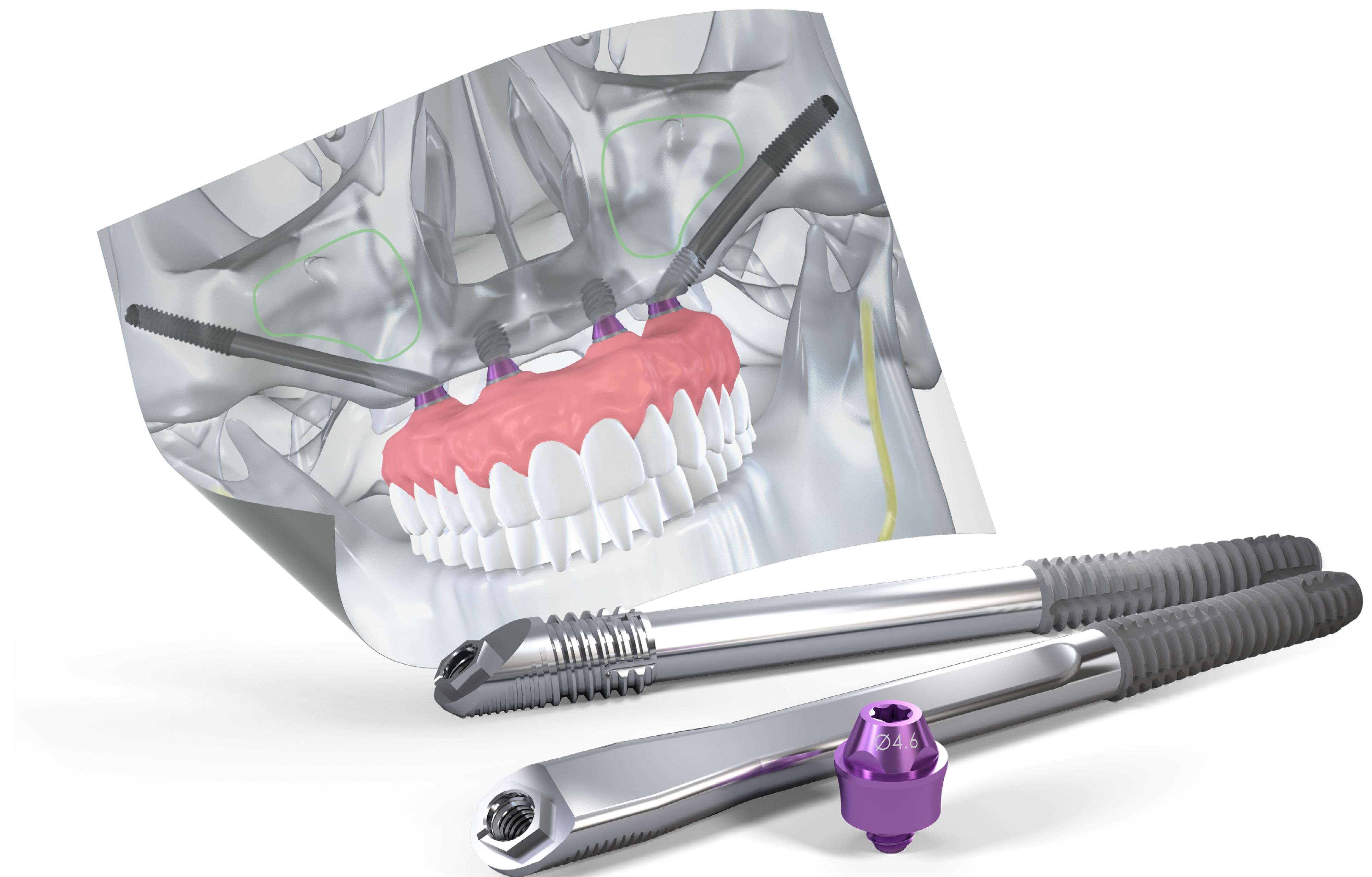





What's in it for you?

## Straightforward prosthetics

- Prosthetic portfolio with a single implant connection; compatible with Straumann® Edentulous Solutions.



3 Boyes-Varley JG, Howes DG, Lownie JF, Blackbeard GA. Surgical Modifications to the Branemark Zygomaticus Protocol in the treatment of the severely resorbed Maxilla: A Clinical Report. Int. J Oral Maxillofac. Implants 2003;18:232–237.

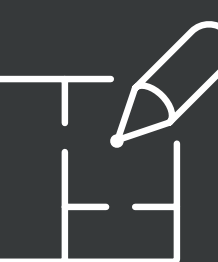



What's in it for you?

# Two implants designed to adapt to patient's anatomy.

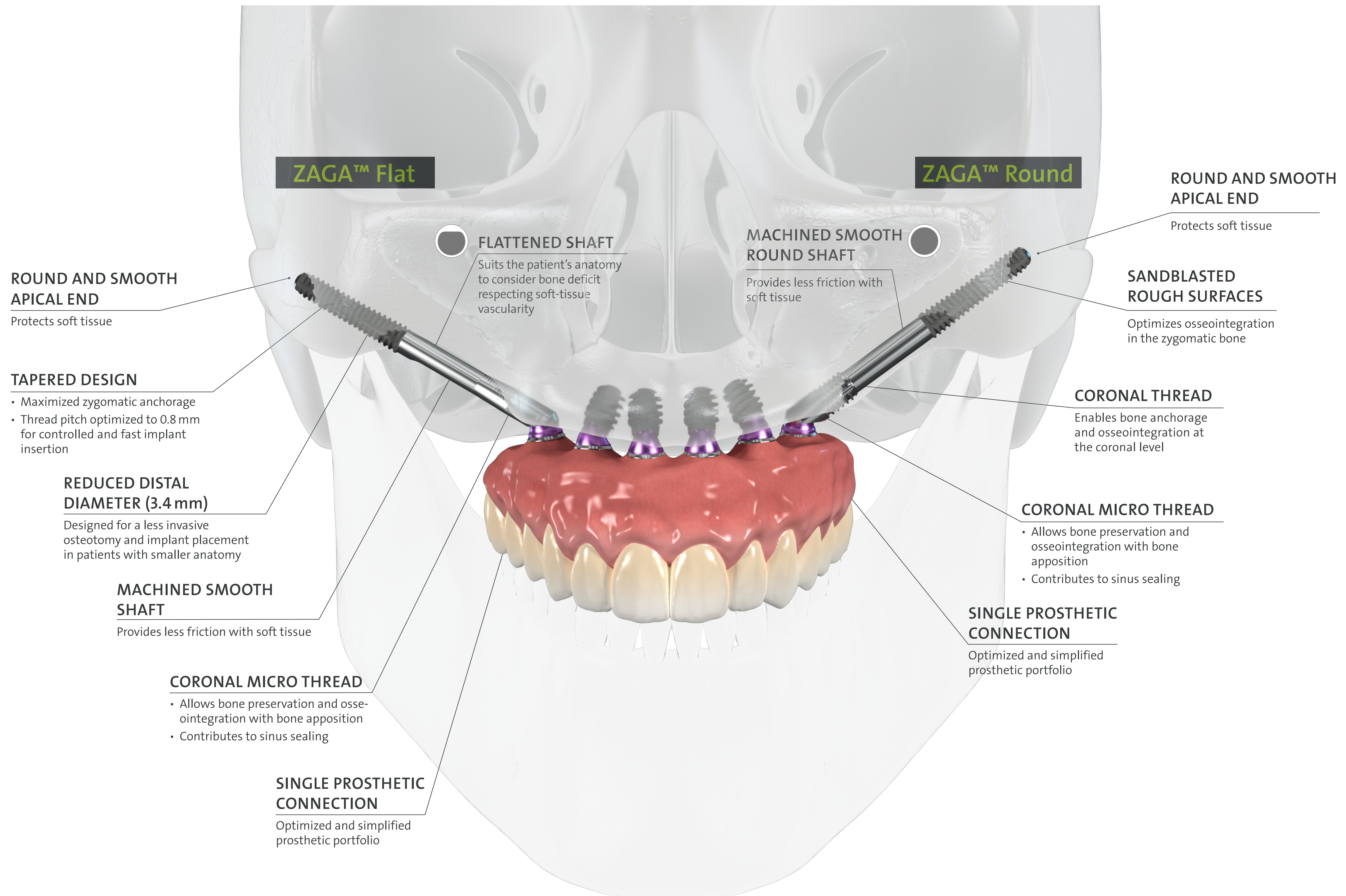



# Clinical cases



**Dr. Carlos Aparicio**

Spain

The ZAGA Concept for a minimally invasive “Canal Osteotomy” combined with the use of a Straumann® Zygomatic.



**Dr. Jean Baptiste Verdino**

France

Full arch maxillary rehabilitation avoiding cantilevers with Straumann® Zygomatic implants.



**Dr. Sepehr Zarrine**

France

Bimaxillary full edentulous graftless rehabilitation with Straumann® Zygomatic Implants and Straumann® Mini Implants.





# Technical information

Straumann® Zygomatic Implants  
product range

55° platform for a proper restorative  
position

Straumann® Zygomatic Screw-retained  
Abutment ZAGA™

Straumann® Zygomatic Surgical Tray

Treatment planning with coDiagnostics®





# Straumann® Zygomatic Implants

## Product Range

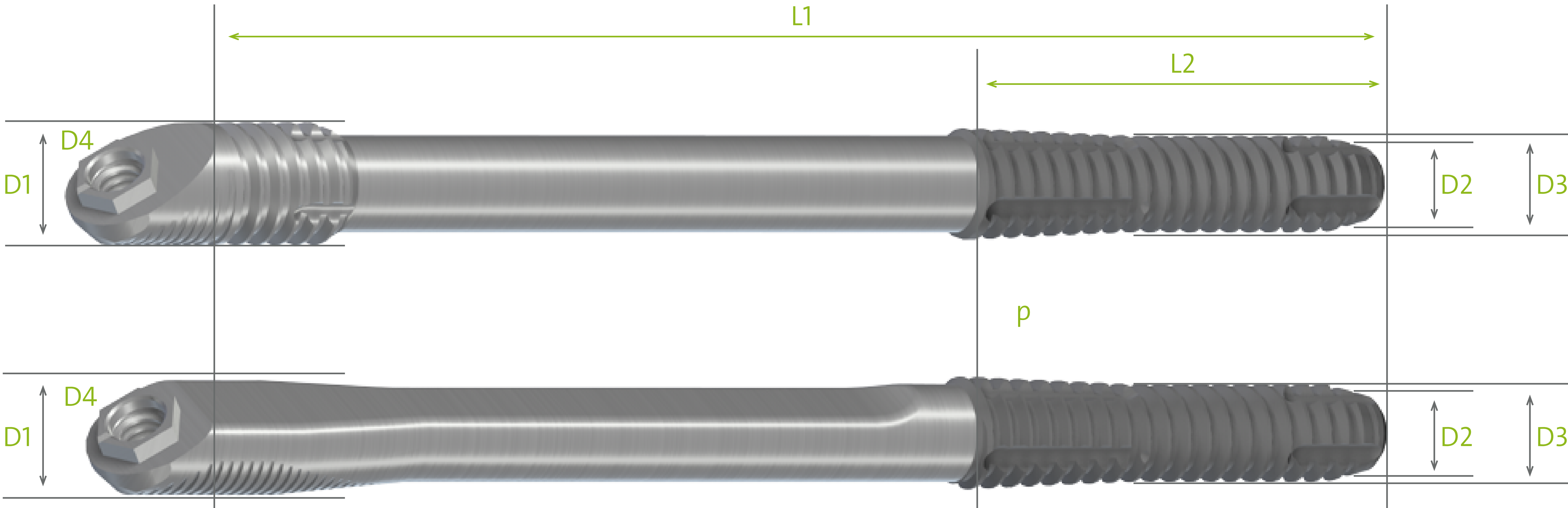

	Coronal Ø (D1)	Apical Ø (D2)	Distal Ø (D3)	Thread length (L2)	Platform angle (D4)	Thread pitch (p)	Implant length in mm (L1)										
							30.0	32.5	35.0	37.5	40.0	42.5	45.0	47.5	50.0	52.5	55.0
ZAGA™ Round	4.3 mm	2.6 mm	3.4 mm	17 mm	55°	0.8 mm			✓	✓	✓	✓	✓	✓	✓	✓	✓
ZAGA™ Flat	4.3 mm	2.6 mm	3.4 mm	17 mm	55°	0.8 mm	✓	✓	✓	✓	✓	✓	✓	✓	✓	✓	





# 55° platform for a proper restorative position

- The 55° platform accommodates a higher angle for the restorative position.
- No need for angulated abutments.

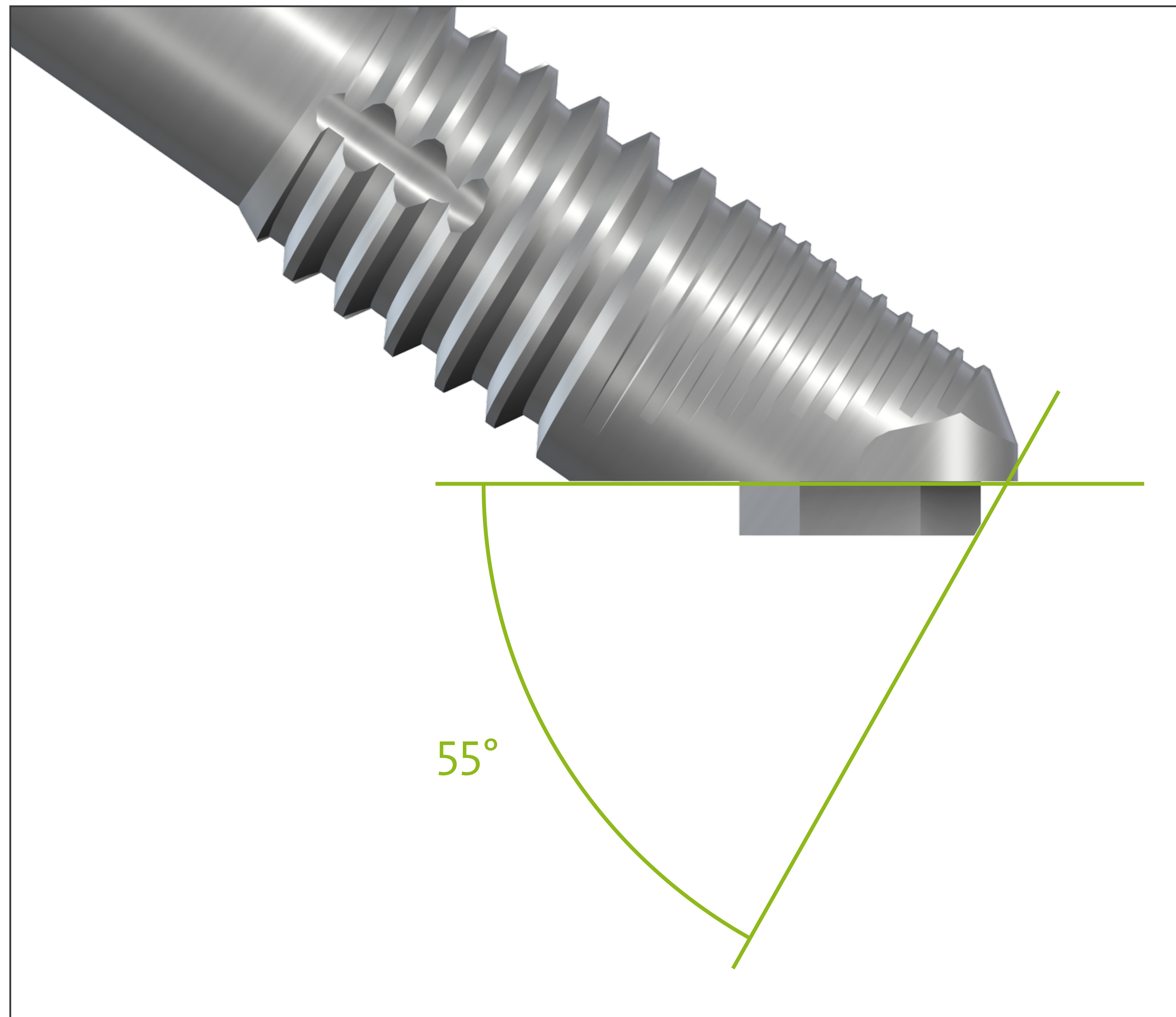



# Straumann® Zygomatic Screw-retained Abutment ZAGA™

- Ensures compatibility with the Straumann® Bone Level prosthetic portfolio for fixed overdentures including copings and impression materials.



Gingiva height (GH)			
1.5 mm	2.5 mm	3.5 mm	4.5 mm
✓	✓	✓	✓





# Straumann® Zygomatic Surgical Tray

## Instruments for an optimal placement

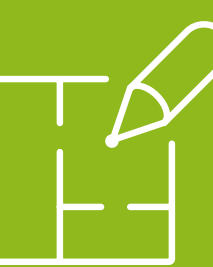
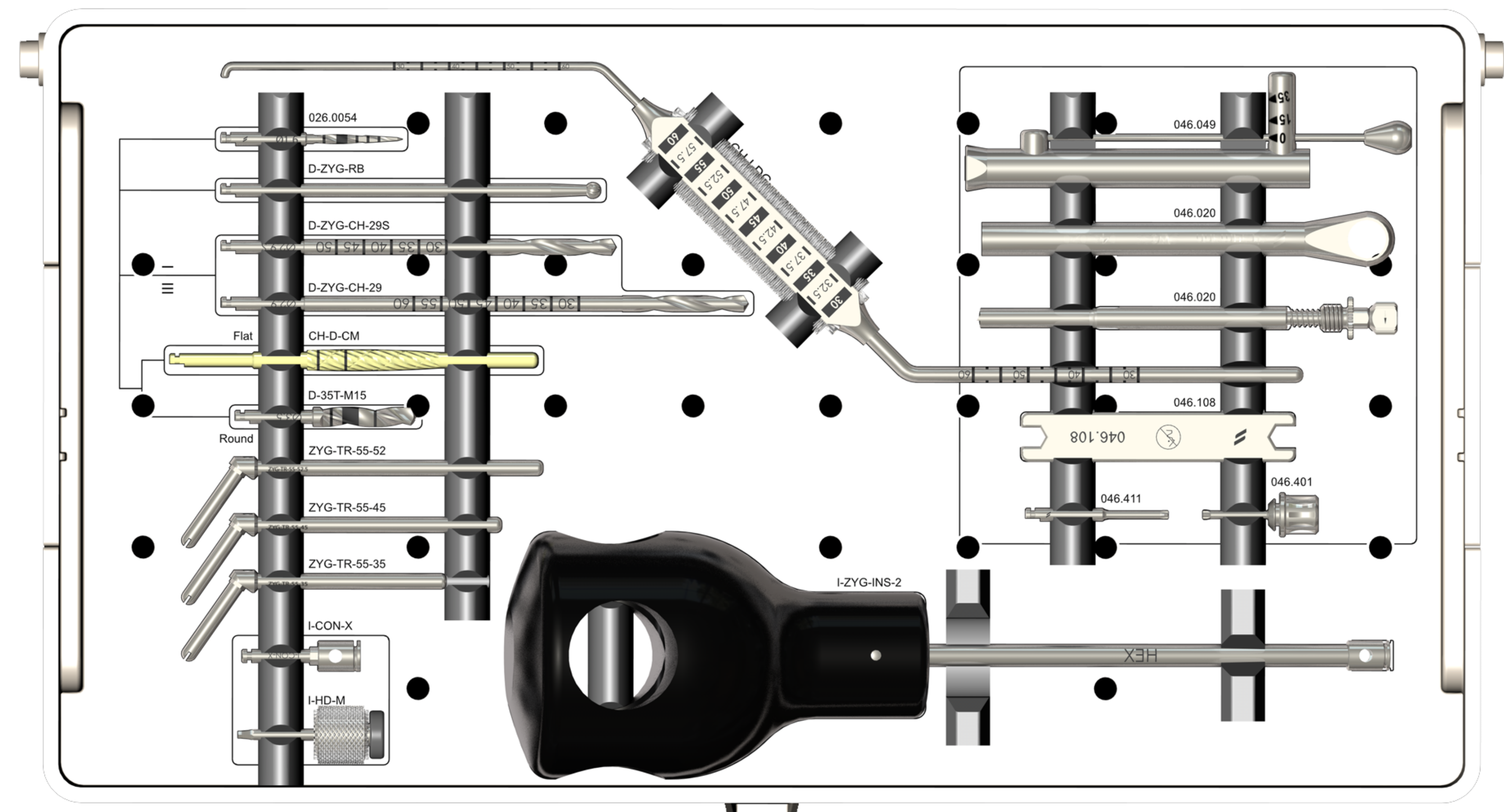
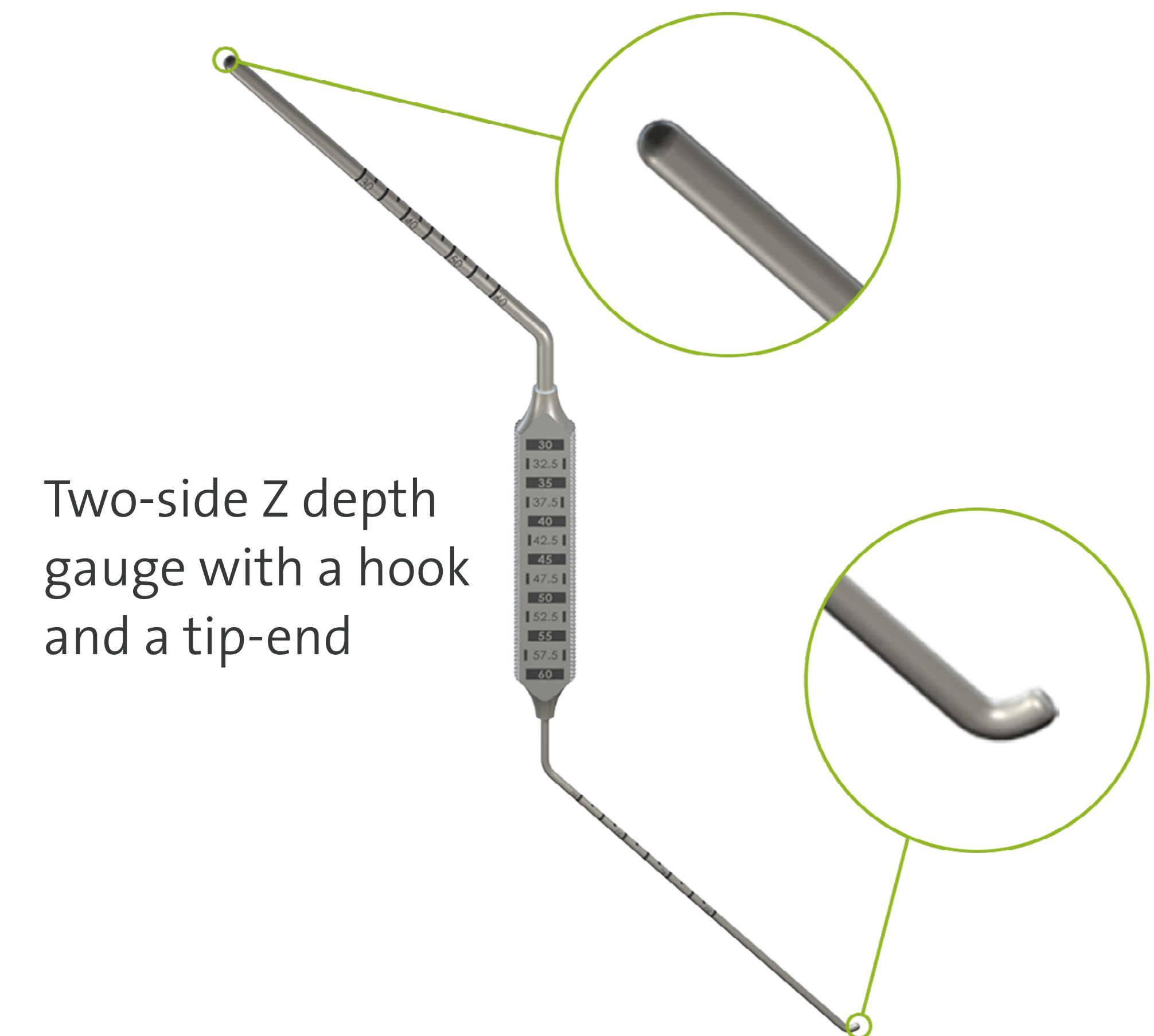
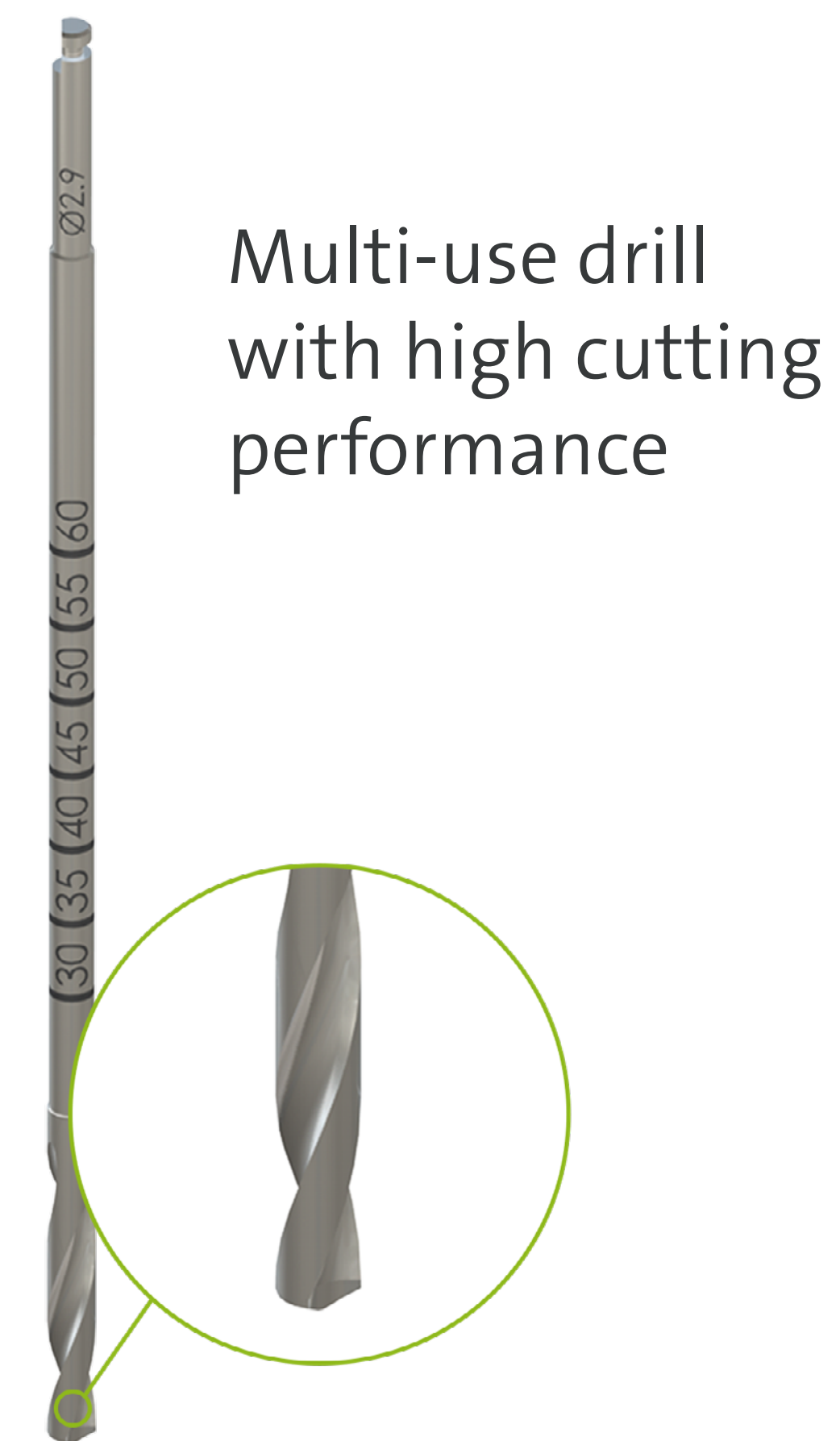
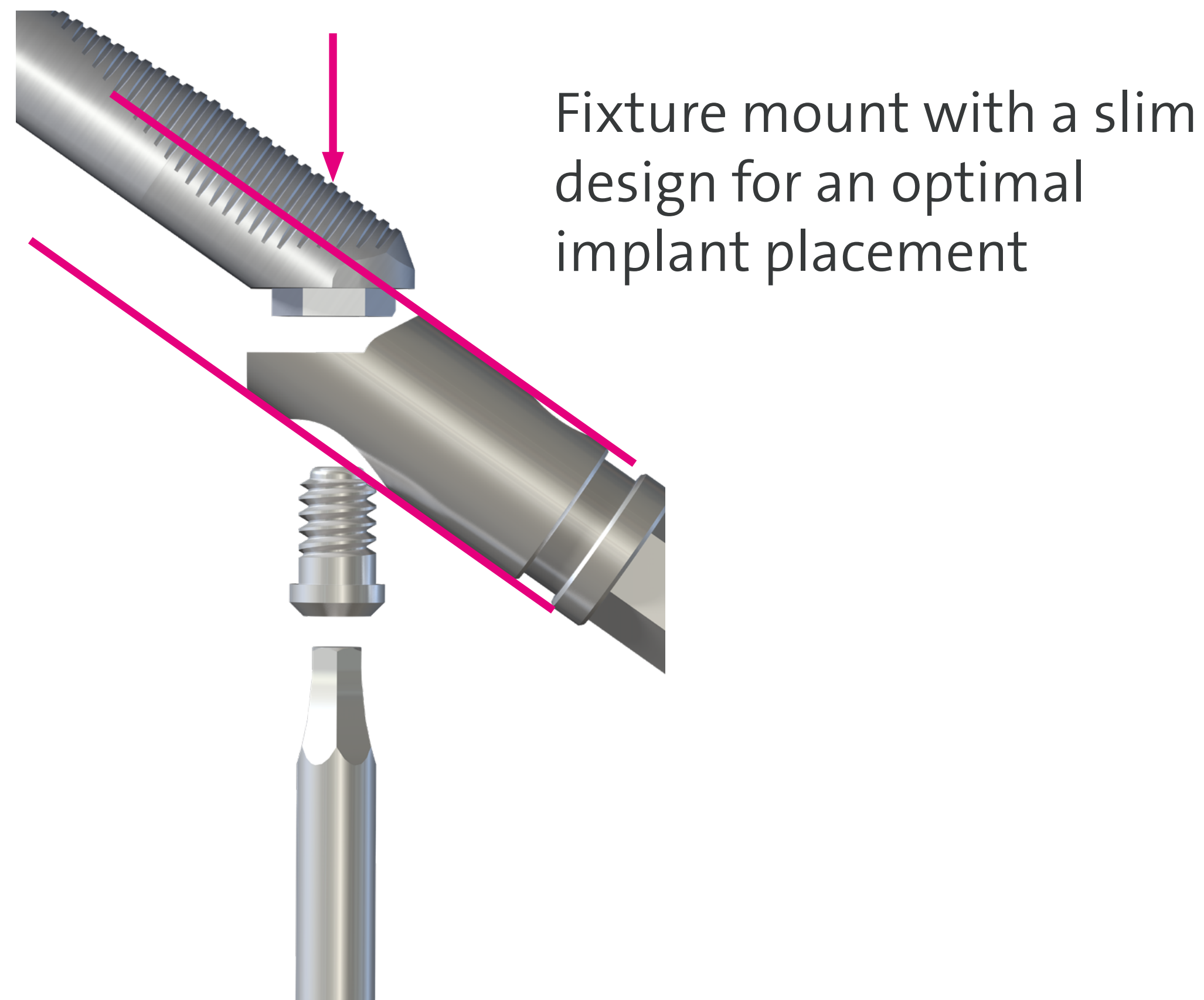



# Treatment planning with coDiagnostiX®

- Integration of Straumann® Zygomatic Implant System components data in our digital implant placement software coDiagnostiX® enables to plan fully edentulous cases precisely and easily.





# What customers say



**Dr. Carlos Aparicio**

Barcelona, Spain

“ZAGA™ Flat design allows a significantly more...”



**Dr. Sepehr Zarrine**

Saint-Dié-des-Vosges, France

“The two implant designs with differentiated surfaces are a wise solution...”



**Dr. Edmond Bedrossian**

San Francisco, USA

“The Straumann® Zygomatic implant allows for the treatment of any maxillary condition...”







What customers say

## Clinician statement: Dr. Carlos Aparicio

Barcelona, Spain



« ZAGA™ Flat design allows a significantly more conservative osteotomy and better bone sealing while avoiding soft tissue compression. »







What customers say

## Clinician statement: Dr. Sepehr Zarrine

Saint-Dié-des-Vosges, France



«The two implant designs with differentiated surfaces is a wise solution that can be used by any zygomatic surgeon and can be adapted to different patient anatomies.»







What customers say

## Clinician statement: Dr. Edmond Bedrossian

San Francisco, USA



«The Straumann® Zygomatic implant allows for the treatment of any maxillary condition...it provides the Total Solution for the immediacy concept.»





# Summary

- Provides edentulous patients with an immediate and predictable fixed solution
- Unique implant designs and straightforward prosthetic concept
- Tailored solutions for patients with various anatomy types and bone deficits
- Compatibility with Straumann® BLX and BLT implants and prosthetics for fixed overdenture
- Integration of Straumann® Zygomatic Implant System components in coDiagnostiX®

